



MRI Compatible Straight Cove RGB LED Luminaire



Product Description

The Sentient Suite™ Straight Cove LED Luminaire is a non-ferrous, ceiling mount luminaire for use as an interior architectural design feature and accent lighting. The Straight Cove LED Luminaire may be used anywhere within a Healthcare Facility including MRI Scan Rooms.

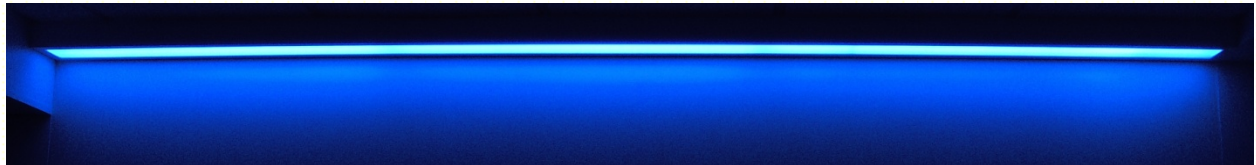

Specifications

Material

- Structure: Aluminum
- Fasteners: Stainless Steel

Lens

- Light Diffusing Polymer

Finish

- Exposed Face: Powder Coat

Dimensions

- 80.00"l x 6.0"w x 4.09"d
- 2032 x 152.4 x 103.9mm
- 15lbs/6.8kg

Electrical Input

- 12 VDC, 4-wire RGB
- Electrical Junction Box

Construction

- Welded/Mechanically Fastened

LEDs

- (3) 1m RGB LED Light Strips/80"
- Lumens: 344.11
- Efficacy: 29.17
- Color Rendering Index: 17.2
- Color Related Temperature: 52600
- 60 LED's / 1m (3.28')
- Red/Green/Blue

Warranty

- One Year Limited
- Complete Component

Approval Listings

- ETL / CSA / CE

™ Sentient Suite is a Trademark of PDC Facilities, Inc.



3D Installed View

Standard installation is six pieces
(Connected end-to-end, 3 per side)

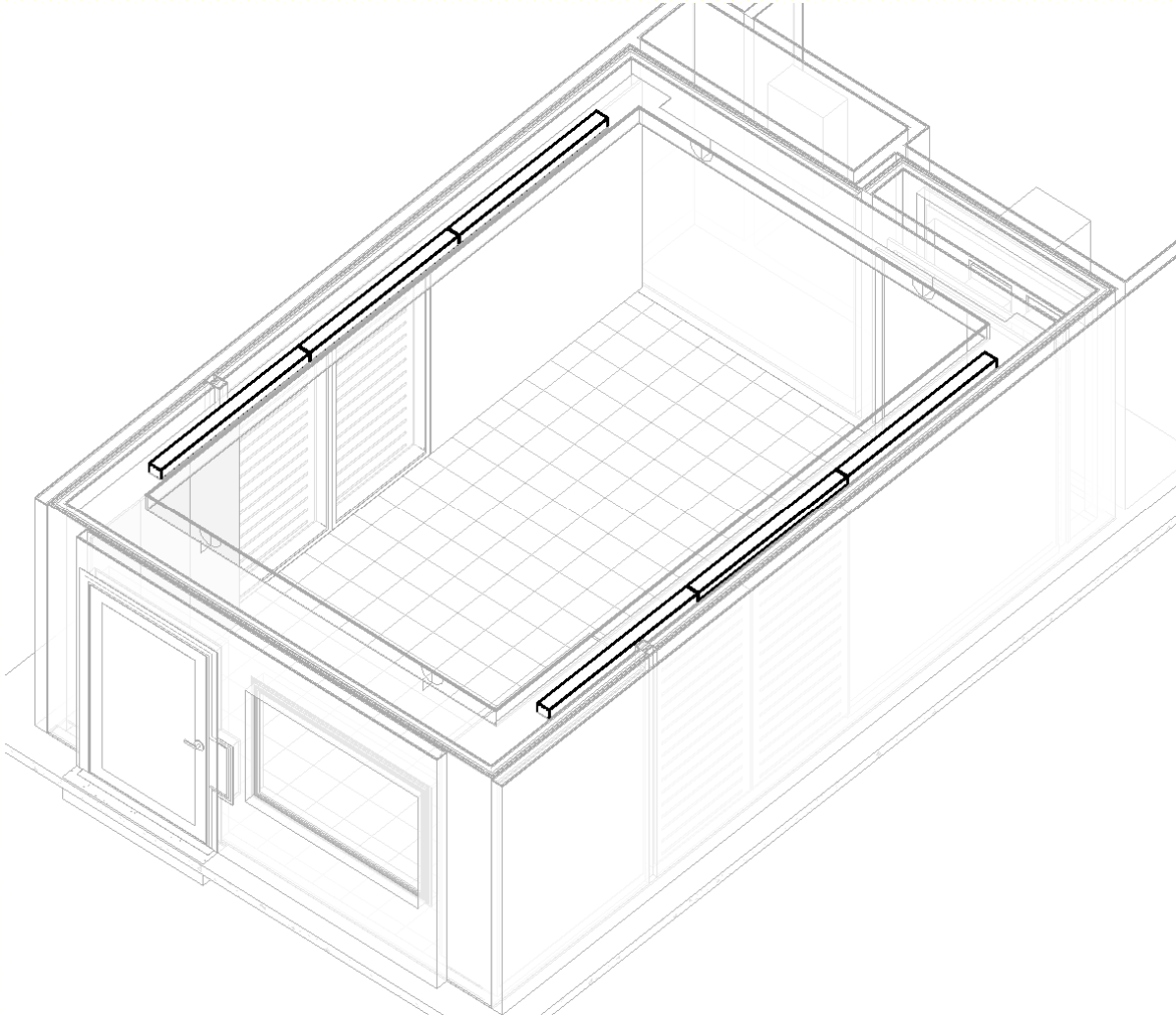

3D transparent view with highlighted “Straight Cove Lights”



Physical Properties

Dimensions: 80"l x 6"w x 4.09"d (2032 x 152.4 x 103.9mm)

Weight: 15 lbs. (6.8kg)

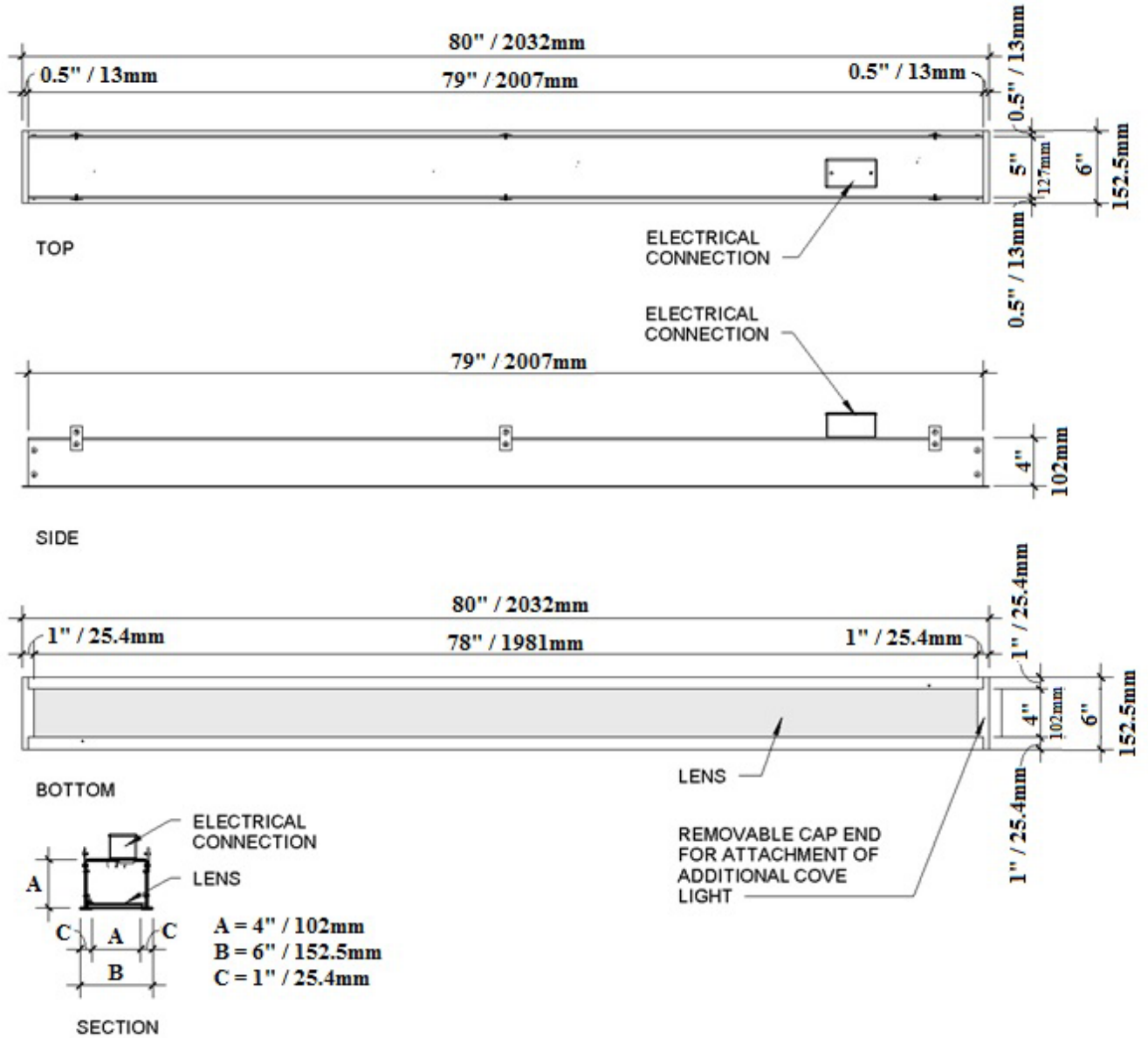



Installation Detail Section Detail A (direct fastening)

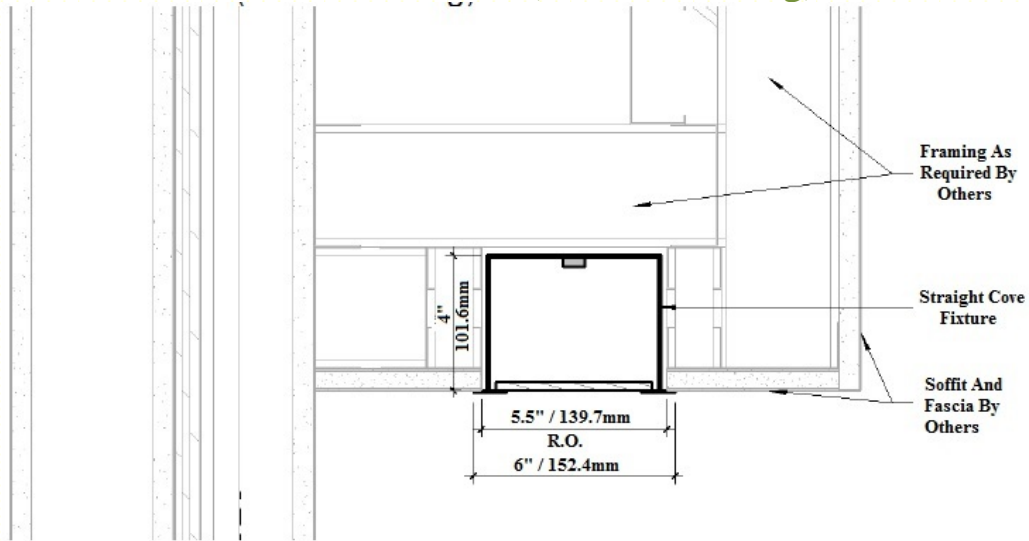

Section Detail B (hung by wire)

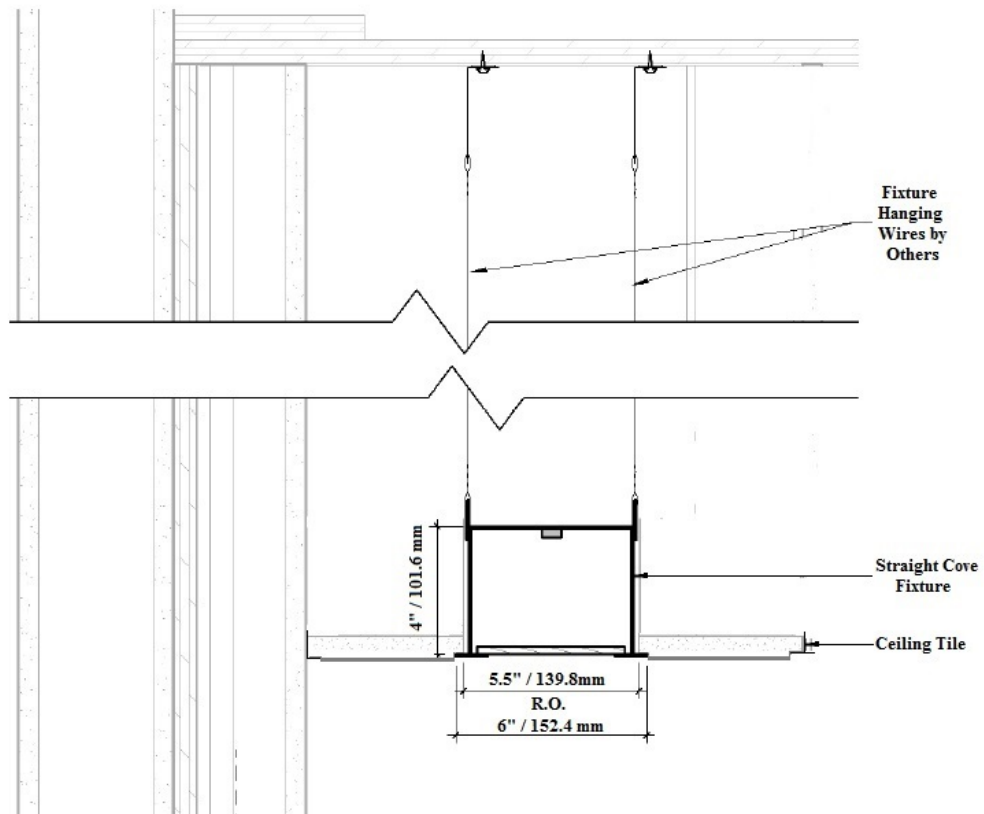



Section Detail C (flush to wall)

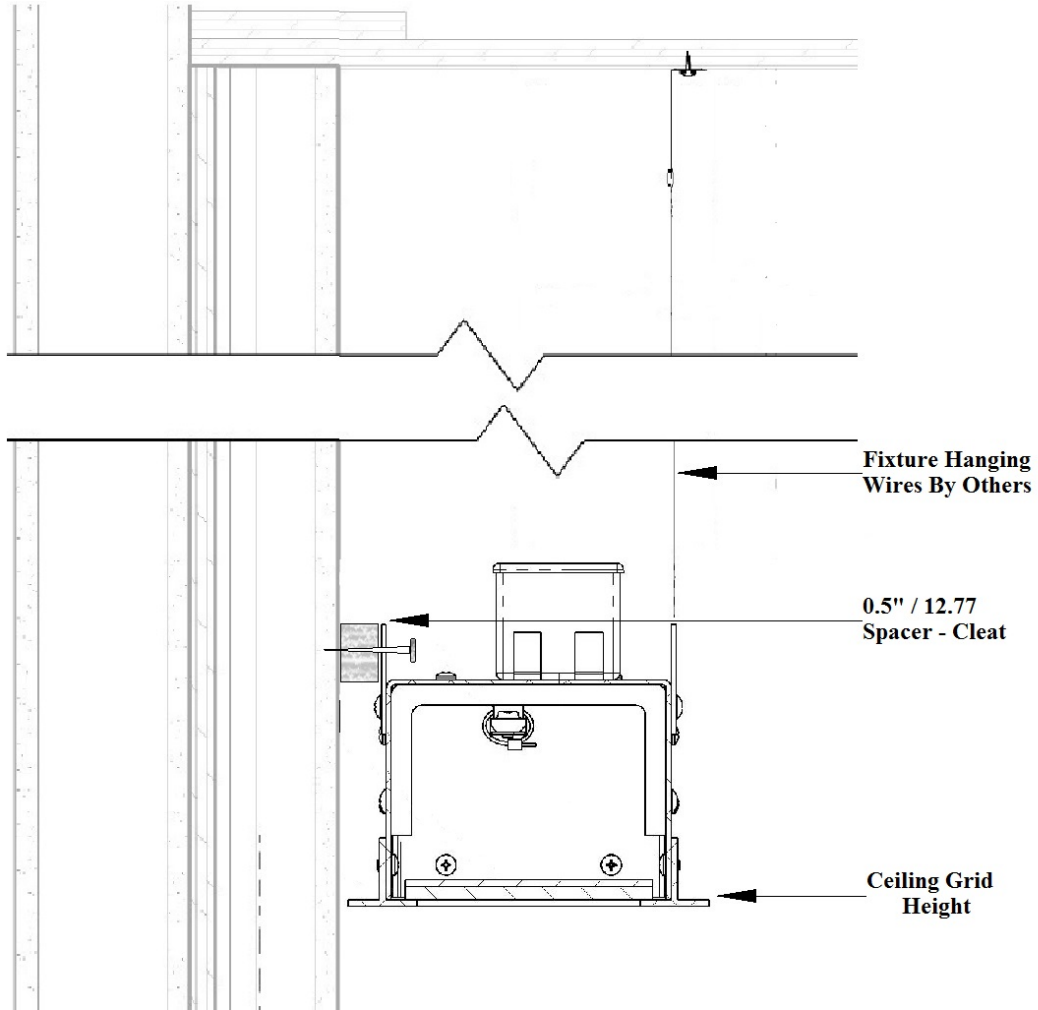

Circuit Diagram

